

Robust Detail E-WT-1



Twin timber frames with sheathing boards, minimum 50mm cavity.

February 2018

Benefits:

- Party Wall Thermal Bypass - Full-fill solution to aid zero u-value compliance.
- No requirement for pre-completion acoustic testing.



Superglass TF Party Wall Roll & TF Party Wall Slab

E-WT-1

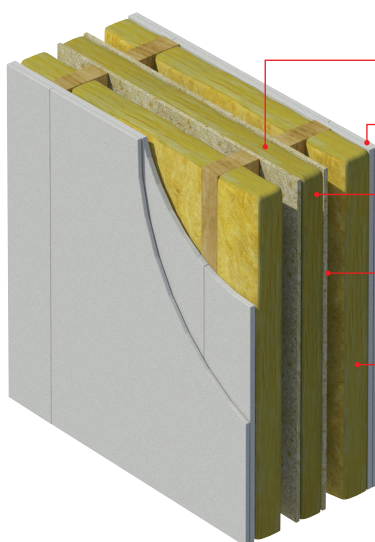

Wall width: 240mm (min) between inner faces of wall linings.
50mm (min) gap between wall panels.

Wall lining: 2 or more layers of gypsum-based board (total nominal mass per unit area 22kg/m²), both sides.

Insulation: Superglass TF Party Wall Roll or TF Party Wall Slab

Sheathing: Partial sheathing of party wall.

Absorbent material: 60mm (min) mineral wool batts or quilt (density 10 - 60kg/m³) both sides i.e Superglass Multi Acoustic Roll, Superglass Timber & Rafter Roll

Ties: Between frames not more than 40mm x 3mm, at 1200mm (min) centres horizontally, one row of ties per storey height vertically.

External (flanking) wall: Outer leaf masonry with minimum 50mm cavity.

The requirements of the Robust Details Handbook should be strictly followed.

Superglass TF Party Wall Roll

Thickness (mm)	Length (m)	Width (mm)	Fire Classification when tested to BS EN 13501-1 Reaction to Fire	Generic BRE Green Guide Rating	Approved Document E (Eng & Wal) Acoustic Performance in excess of 45 dB D _{nT,w} +Ctr(*)	Contributes to zero effective U-value (**)	Code for Sustainable Home Credits
60	10.50	2 x 675	A1 non-combustible	A+	YES	YES	1

Superglass TF Party Wall Slab

Thickness (mm)	Length (mm)	Width (mm)	Fire Classification when tested to BS EN 13501-1 Reaction to Fire	Generic BRE Green Guide Rating	Approved Document E (Eng & Wal) Acoustic Performance in excess of 45 dB D _{nT,w} +Ctr(*)	Contributes to zero effective U-value (**)	Code for Sustainable Home Credits
50	1200	600	A1 non-combustible	A+	YES	YES	1
60	1200	600	A1 non-combustible	A+	YES	YES	1
100	1200	600	A1 non-combustible	A+	YES	YES	1

For more information on the above Robust Detail please visit www.robustdetails.com or call our Technical Team on **0808 1645 134**.

(*) The Part E Robust Details Handbook states that the separating cavity in E-WT-1 may be insulated with mineral wool with a density of 18 - 40kg/m³ - Superglass TF Party Wall Roll fulfils this requirement. Acoustic testing has been completed to demonstrate suitability in the above construction. If this solution were used on site with an equivalent construction and the same build quality, it would achieve the sound insulation performance level required by Approved Document E (England and Wales).

Northern Ireland: The Department of Finance and Personnel has accepted the Robust Details scheme as the alternative to pre-completion sound testing to demonstrate compliance with Part G (NI) for new dwellings. Builders wishing to register and construct plots in Northern Ireland can use the Part E (E&W) Handbook and documentation.

Superglass Insulation Limited

Thistle Industrial Estate, Kerse Road, Stirling, Scotland FK7 7QQ

TECHNICAL

Hotline: **0808 1645 134**

Email: technical@superglass.co.uk

SALES

Tel: **01786 451170**

Email: sales@superglass.co.uk



www.superglass.co.uk

Your insulation team
Superglass

A TECHNICAL company